

CPA

CPA SERIES LOW PROFILE COMPRESSION LOAD CELLS



C3

Stainless steel compression load cells suitable for extremely harsh environments and high temperatures.

CAPACITIES (kg): 150, 300, 500, 1000, 2000, 3000, 5000, 7000, 10000, 20000, 30000, 50000.

OIML R60, C3 precision class from 2000 a 10000kg.

Stainless steel. IP68 protection.

Working in cooperation with:



The best solution
for advanced industrial
applications

MAIN FEATURES

- CAPACITIES from 150 to 10000 kg
- OIML C3 CLASS, from 2000 to 10000 kg
- LOW PROFILE
- GREAT RESISTANCE TO LATERAL FORCES
- STAINLESS STEEL CONSTRUCTION
- IP68 PROTECTION
- SHIELDED CONNECTION CABLE UP TO 90°C

TECHNICAL FEATURES

- Minimum load cell verification interval: $V_{min} = E_{Max} / 10000$
- Full Scale Output: 2mV/V +/- 0,1% (1,3mV/V for CPA150)
- Repeatability: 0,01% F.S.
- Temperature effect on zero: 0,0014% /°C
- Temperature effect on full scale output: 0,0013% /°C
- Compensated Temperature Range: -10°C/+40°C
- Operating Temperature Range: -30°C/+60°C
 - * Upon request up to 200°C
- Creep error after 4 hours: 0,03% F.S.
- Maximum tolerated excitation voltage: 15 Vdc
- Input Resistance: 1100 ± 50 Ohm
- Output Resistance: 1000 ± 10 Ohm
- Zero Balance: $\pm 2\%$ F.S.
- Insulation Resistance: >5000 MOhm
- Safe Overload: 150% F.S.
- 6-wire shielded cable, 5 mm diameter:
 - 5 m long for the versions from 150 up to 10000kg
 - 15 m long for the versions from 20000 to 50000kg

MAIN CERTIFICATIONS

- OIML R60
- Australian legal for trade certificate of approval (NMI S838)

•

<u>Wiring Code</u>	
<u>Colour</u>	<u>Function</u>
METAL	SHIELD
GREEN	OUTPUT +
VIOLET	SENSE +
RED	INPUT +
WHITE	OUTPUT -
GREY	SENSE -
BLACK	INPUT -

ATEX Version

- The CCATEX certificate makes the load cell suitable for use in hazardous areas with protection methods according to:
ATEX II 1G Ex ia IIC T6 (Ta -20÷+40°C) TX (Ta -20÷+65°C)
ATEX II 1D tD A20 TX°C (Ta -20÷+40°C) TX°C (Ta -20÷+65°C).
The certificate includes the manual and the ATEX CE conformity declaration (available in EN, DE, FR, and IT).
- The CCATEX certificate is issued after the checks done by qualified technicians, with the help of specific equipments, for each load cell.
- IMPORTANT: the certificate refers to the single load cell. For systems with more load cells, it is necessary to order one certificate for each load cell.

VERSIONS

Available versions

Codice	Max (kg)
CPA150	150
CPA300	300
CPA500	500
CPA1000	1000
CPA2000 	2000
CPA3000 	3000
CPA5000 	5000
CPA7000 	7000
CPA10000 	10000
CPA20000	20000
CPA30000	30000
CPA50000	50000

NOTE: Capacities up to 1000t upon request.



www.diniargeo.com

“YOUR WORLDWIDE PARTNER FOR WEIGHING,”

DINI ARGEO
FRANCE sarl
France

DINI ARGEO
GMBH
Germany

DINI ARGEO
UK Ltd
United Kingdom

DINI ARGEO WEIGHING
INSTRUMENTS Ltd
China

DINI ARGEO
OCEANIA
Australia



COMPANY HEADQUARTERS

Via Della Fisica, 20
41042 Spezzano di Fiorano - Modena - Italy
Tel. +39.0536 843418

SALES AND TECHNICAL ASSISTANCE SERVICE

150 / 300 / 500 / 1000 / 2000 / 3000 / 5000 / 7000 / 10000

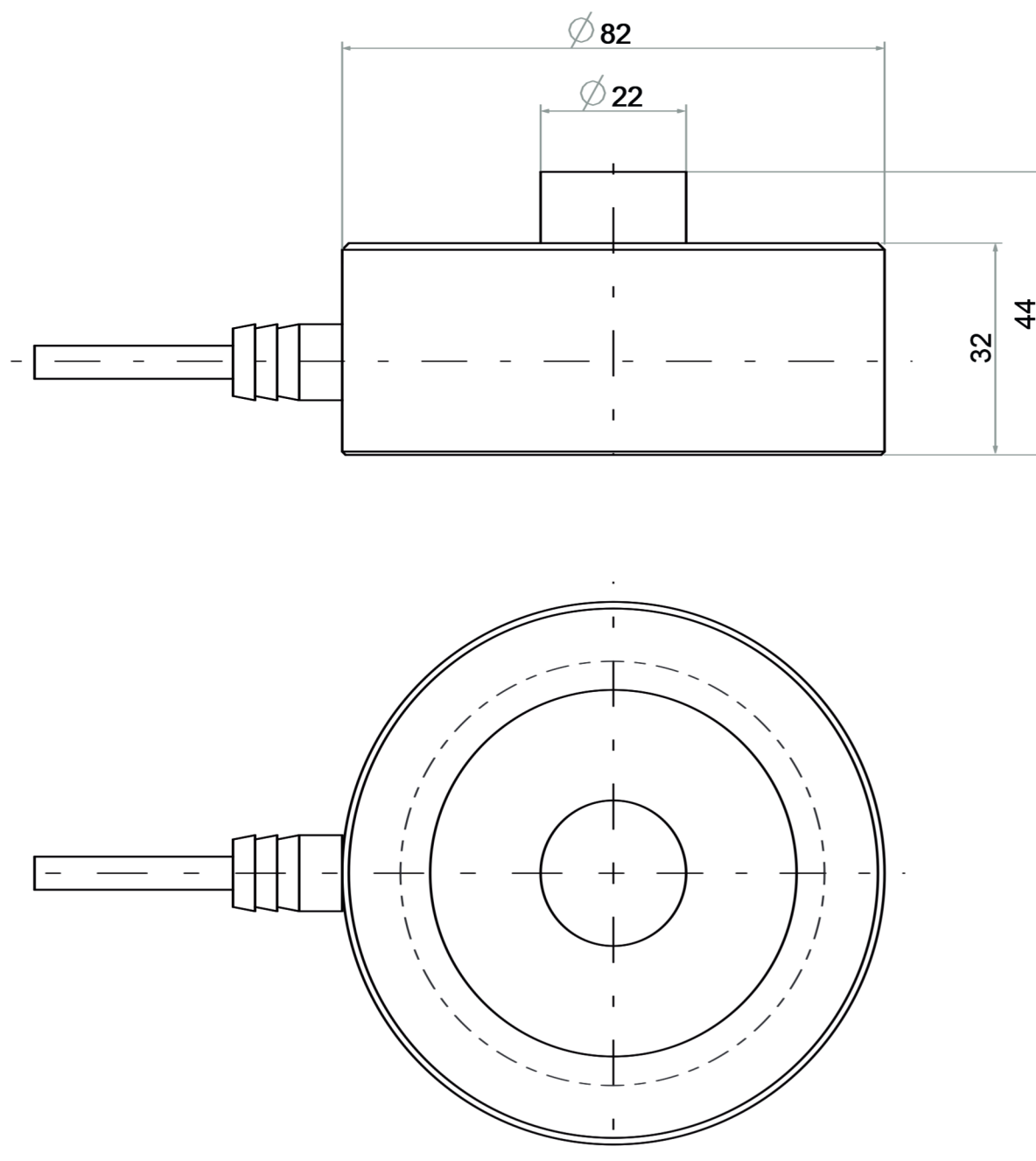

dimensions in mm

CPA

20000 / 30000 / 50000

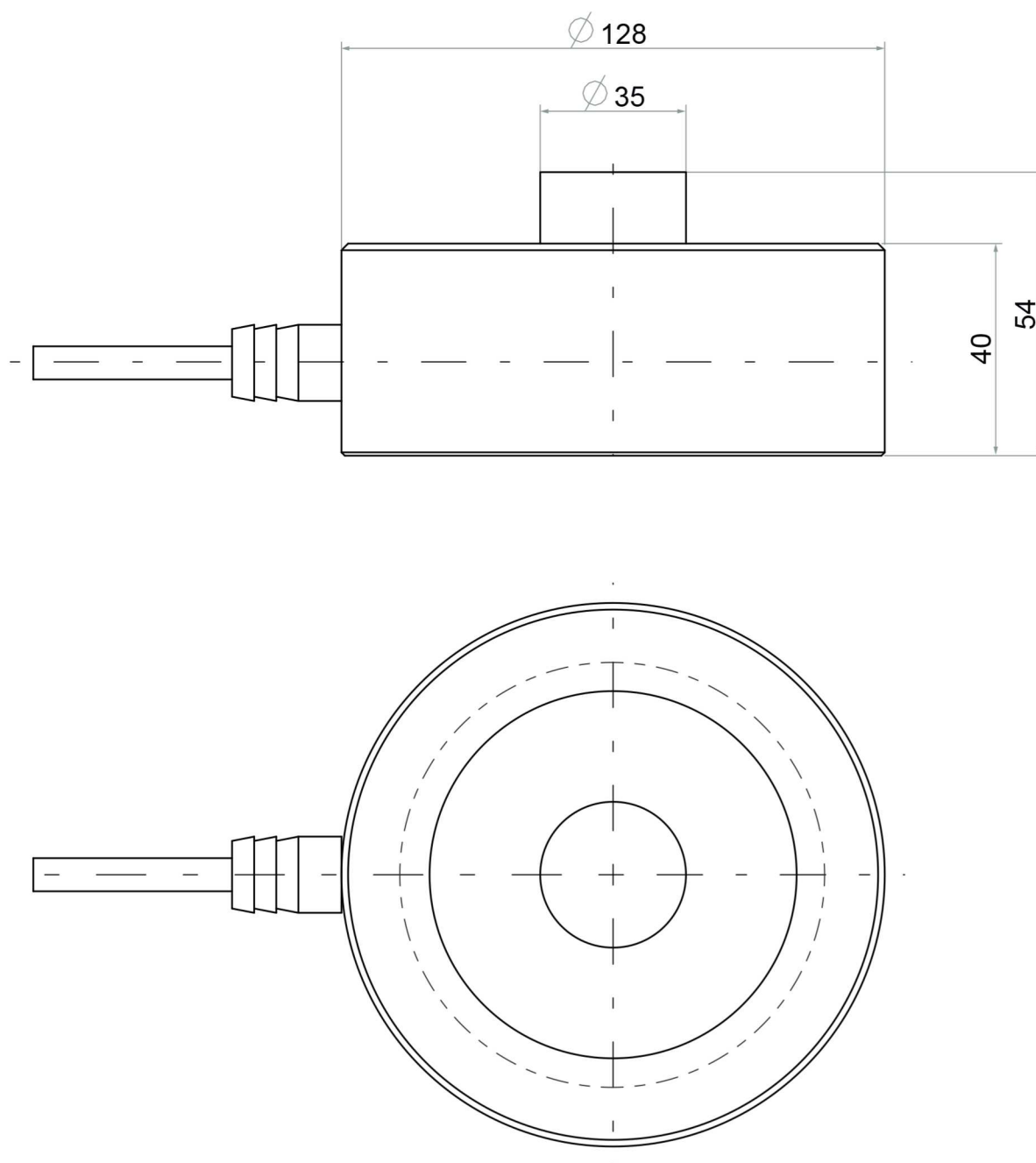

dimensions in mm